

How to Measure Sky Lounger Covers - Design 6

Measurement Instruction

- ✓ Give exact measurement from edge to edge.
- ✓ "We add upto 2" leeway on the given width/depth for easy pull-in and pull-out."
- ✓ The height dimensions will remain same as provided by you.

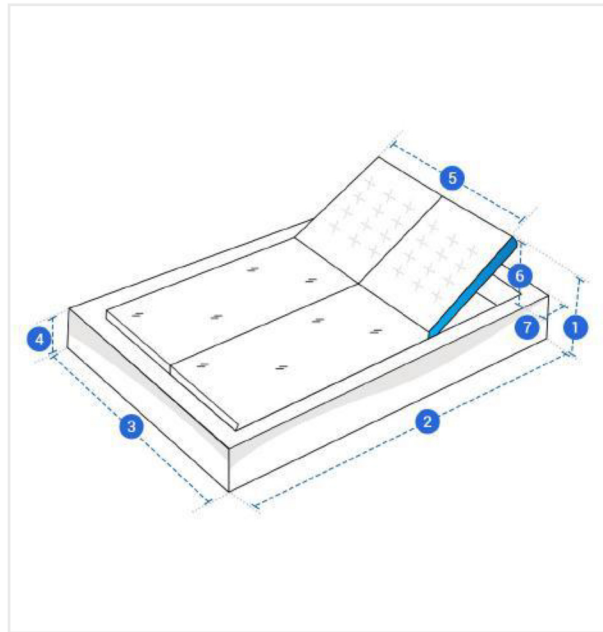

Measurement (Inches)

1. Back Height

3. Front Width

5. Back Width

7. Length From Adjustable Headrest Top Height To Corner

2. Depth

4. Front Height

6. Adjustable Headrest Height

1. Back Height:
Back Height of the Sky Lounger

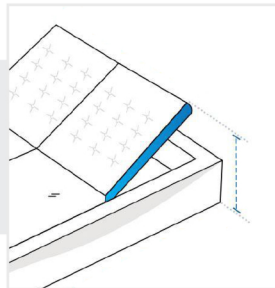

2. Depth:
Depth of the Sky Lounger

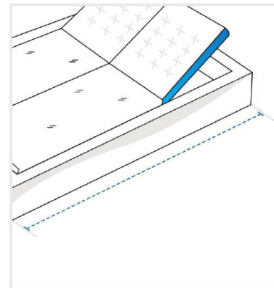

3. Front Width:
Front Width of the Sky Lounger

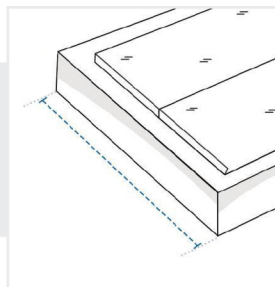

4. Front Height:
Front Height of the Sky Lounger

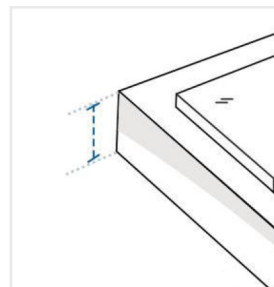

5. Back Width:
Back Width of the Sky Lounger

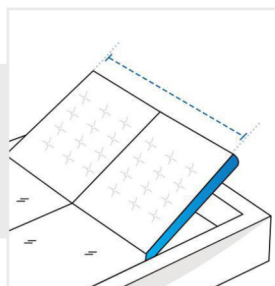

6. Adjustable Headrest Height:
Adjustable Headrest Height of the Sky Lounger

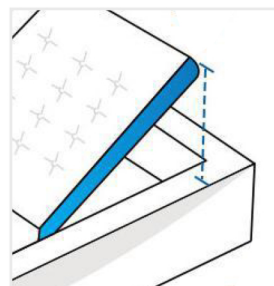

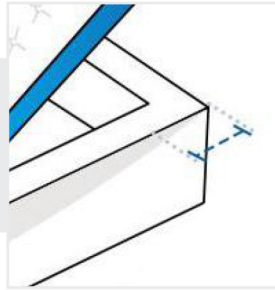

7. Length From Adjustable Headrest Top Height To Corner:

Length From Adjustable Headrest Top Height To Corner of the Sky Lounger