

# How to Measure Outdoor Bar Island Covers - Design 2

## Measurement Instruction

- ✓ Give exact measurement from edge to edge.
- ✓ We add 1" to 2" leeway on the given width/depth for easy pull-in and pull-out.
- ✓ The height dimensions will remain same as provided by you.

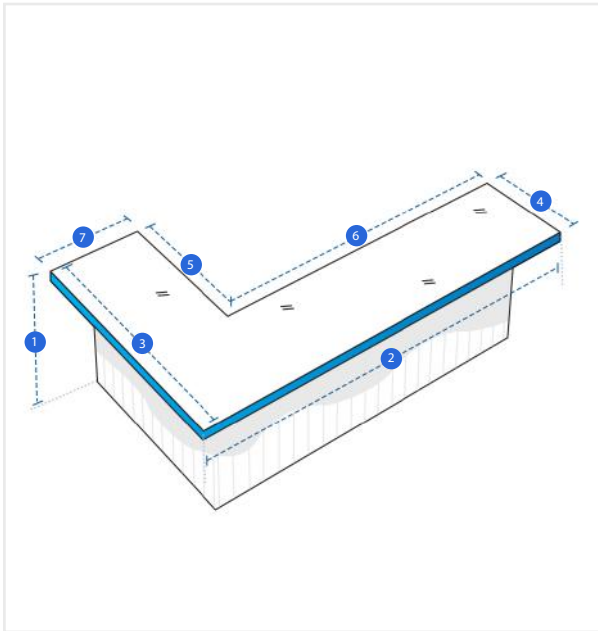

### Measurement (Inches)

1. Height	<input type="text"/>	2. Width	<input type="text"/>
3. Left Outer Depth	<input type="text"/>	4. Depth	<input type="text"/>
5. Left Inner Depth	<input type="text"/>	6. Inner Width	<input type="text"/>
7. Arm Width	<input type="text"/>		

**1. Height:**  
Height of the Outdoor Bar Island

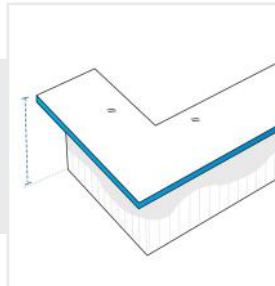

**2. Width:**  
Width of the Outdoor Bar Island

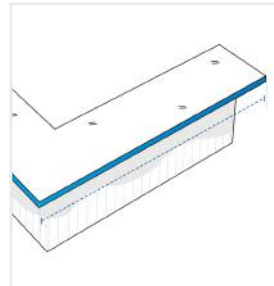

**3. Left Outer Depth:**  
Outer Depth (Left) of the Outdoor Bar Island

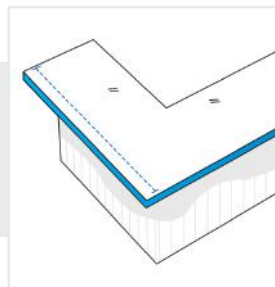

**4. Depth:**  
Depth of the Outdoor Bar Island

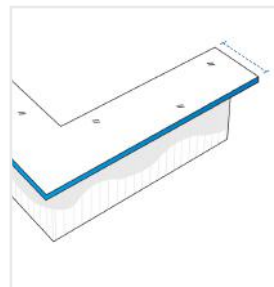

**5. Left Inner Depth:**  
Inner Depth (Left) of the Outdoor Bar Island

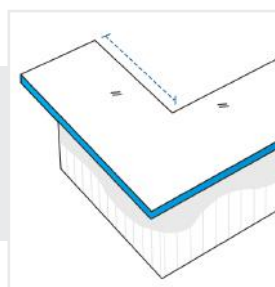

**6. Inner Width:**  
Inner Width of the Outdoor Bar Island

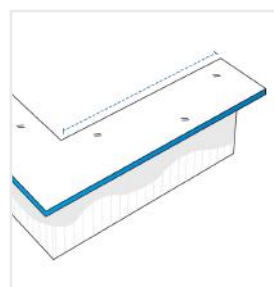

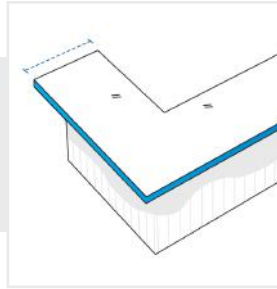

**7. Arm Width:**

Arm Width of the Outdoor Bar Island

We encourage you to upload the image of the article you need the cover for - this helps our team ensure covers are designed keeping your requirements in mind.