

How to Measure Custom Cordless Snowblower Cover

Measurement Instruction

- ✓ Give exact measurement from edge to edge.
- ✓ We add 1" to 2" leeway on the given width/depth for easy pull-in and pull-out.
- ✓ The height dimensions will remain same as provided by you.

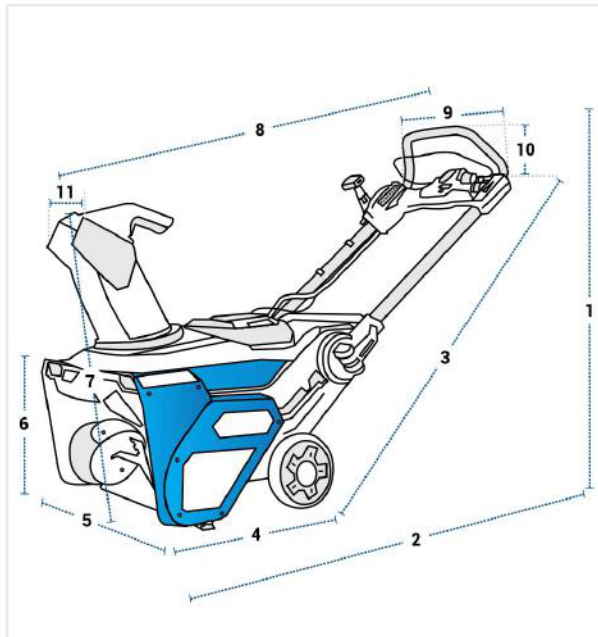

Measurement (Inches)

1. Back Height	<input type="text"/>	2. Depth	<input type="text"/>
3. Inclined Height	<input type="text"/>	4. Depth till tyre	<input type="text"/>
5. Front Width	<input type="text"/>	6. Front Height #1	<input type="text"/>
7. Total Front Height	<input type="text"/>	8. Depth from chute to handle	<input type="text"/>
9. Handle Width	<input type="text"/>	10. Handle Depth	<input type="text"/>
11. Chute Width	<input type="text"/>		

1. Back Height:
Back Height of the Custom Cordless Snowblower



2. Depth:
Depth of the Custom Cordless Snowblower



3. Inclined Height:
Inclined Height of the Custom Cordless Snowblower

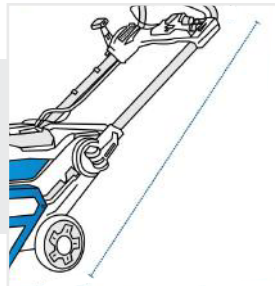

4. Depth till tyre:
Depth till tyre of the Custom Cordless Snowblower



5. Front Width:
Front Width of the Custom Cordless Snowblower

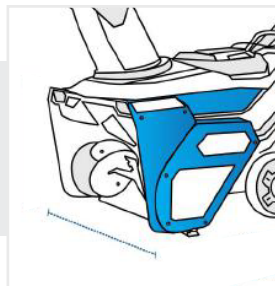

6. Front Height #1:
Front Height (Side #1)

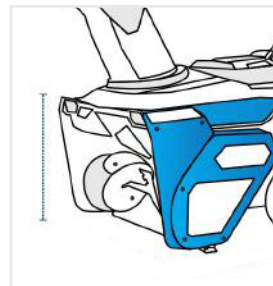

7. Total Front Height:

Total Front Height of the Custom Cordless Snowblower

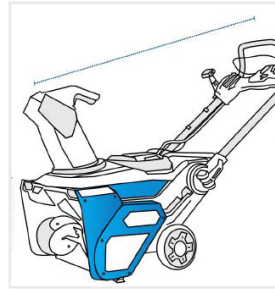
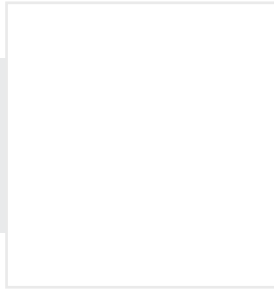

8. Depth from chute to handle:

Depth from chute to handle of the Custom Cordless Snowblower

9. Handle Width:

Handle Width of the Custom Cordless Snowblower

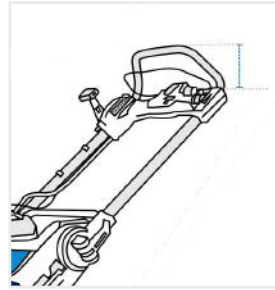
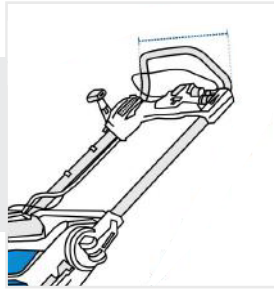

10. Handle Depth:

Handle Depth of the Custom Cordless Snowblower

11. Chute Width:

Chute Width of the Custom Cordless Snowblower

