

How to Measure Hanging Chair Cover - Design 1

Measurement Instruction

- ✓ Give exact measurement from edge to edge.
- ✓ We add 1" to 2" leeway on the given width/depth for easy pull-in and pull-out.
- ✓ The height dimensions will remain same as provided by you.

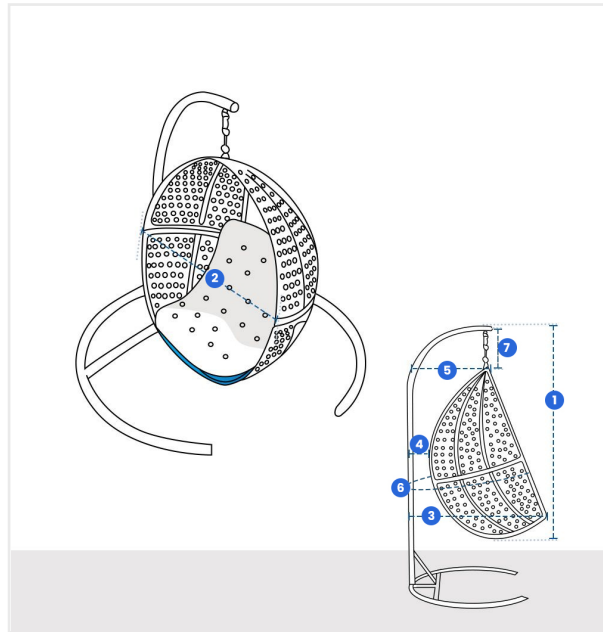

Measurement (Inches)

1. Height From Top Rod To Chair End	<input type="text"/>	2. Width Of The Chair	<input type="text"/>
3. Bottom Depth Include Back Pole	<input type="text"/>	4. Middle Depth Include Back Pole	<input type="text"/>
5. Upper Depth Include Back Pole	<input type="text"/>	6. Back Arch including Pole	<input type="text"/>
7. Hanger Height	<input type="text"/>		

1. Height From Top Rod To Chair End:

Height From Top Rod To Chair End of the Hanging Chair

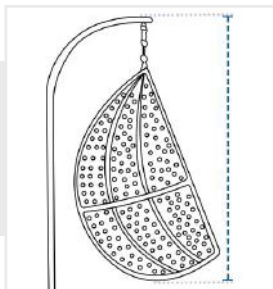

2. Width Of The Chair:

Width Of The Chair of the Hanging Chair

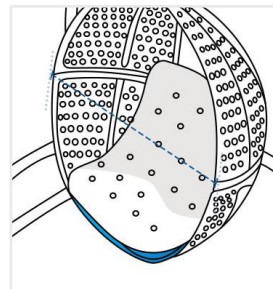

3. Bottom Depth Include Back Pole:

Bottom Depth Include Back Pole of the Hanging Chair

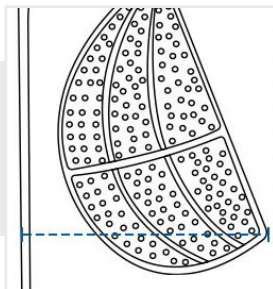

4. Middle Depth Include Back Pole:

Middle Depth Include Back Pole of the Hanging Chair

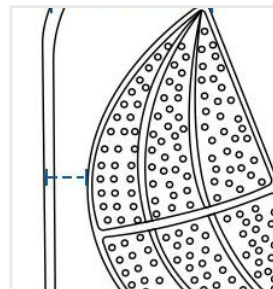

5. Upper Depth Include Back Pole:

Upper Depth Include Back Pole of the Hanging Chair

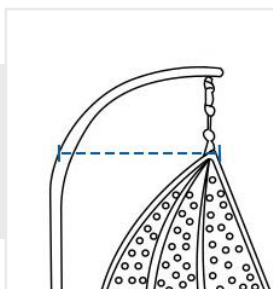

6. Back Arch including Pole:

Back Arch Include Back Pole of the Hanging Chair

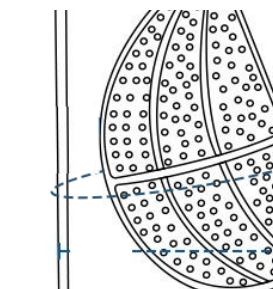

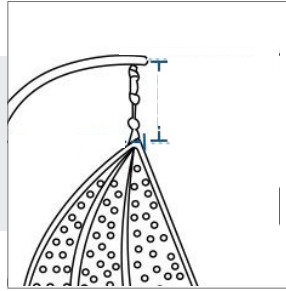

7. Hanger Height:

We encourage you to upload the image of the article you need the cover for - this helps our team ensure covers are designed keeping your requirements in mind.